

RINOLGUARD

Hygienic wall coating

System description

A water based epoxy resin wall coating containing a high activity bactericide. Cures to give a tough impervious film with an easy to clean orange peel finish.

Maximum service temperature

45 °C

Colour range

Available in 10 standard colours. See the RINOL Colour Chart for details.

Benefits

- solvent-free and low odour
- non-tainting
- wide spectrum bactericidal action (test report available)
- durable, tough and impervious
- easy to clean
- good chemical resistance

Areas of use

- food processing plants
- kitchens
- pharmaceutical plants
- hospital wards
- laboratories
- clean rooms

Physical properties

Density

1.31 g/cm³

Working time

35 minutes approx.

Drying time

8 - 15 hours*

Overcoating time

8 - 24 hours*

* dependent upon climatic conditions

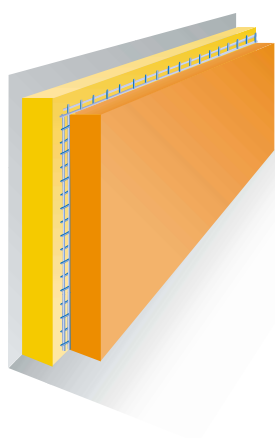

- Second coat
- Glass mesh (optional)
- First coat
- Wall

RINOLGUARD

System description

A water-based dispersion of an epoxy resin designed for use as a hygienic wall coating. RINOLGUARD contains a high activity wide spectrum bactericide. RINOLGUARD is normally applied as a two-coat system with a coverage rate of 125 - 250 g/m² per coat.

Method statement

1. Substrates

- 1.1 Suitable substrates are concrete, polymer modified concrete, brickwork, plaster or plasterboard.
- 1.2 The substrate should be visibly dry.
- 1.3 The substrate must be clean and free from dust and loose particles. All traces of contaminants such as oils, fats, greases, paint residues, chemicals, algae and laitance, should be removed.

2. Preparation

- 2.1 The substrate should be prepared by grit blasting, grinding or wire brushing followed by thorough vacuum cleaning.

3. Priming

- 3.1 No separate priming stage is necessary.

4. Application of the first coat

- 4.1 The two components of RINOLGUARD are mixed using an electric mixer taking care to avoid the inclusion of air.
- 4.2 The mixed components are then applied to the prepared substrate using a lambswool or mohair roller taking care to ensure complete and even coverage.
- 4.3 Coverage should be 125 - 250 g/m² depending upon substrate roughness and porosity.
- 4.4 Optionally, where the substrate is uneven (eg brickwork) or damaged, fibreglass mesh of 100 g/m² may be rolled into the still wet first coat of RINOLGUARD.
- 4.5 RINOLGUARD must not be applied if the temperature falls or is expected to fall to within 3 °C of the dew point.

5. Application of the second coat

- 5.1 The first coat should be allowed to dry for 8 - 24 hours depending on temperature and humidity before application of the second coat.
- 5.2 The second coat should be mixed and applied in exactly the same manner as the first coat taking equal care to ensure even coverage.
- 5.3 Material consumption for the second coat will normally be lower than for the first but should not be less than 125 g/m².

Specification clauses for RINOLGUARD

- 1) The hygienic wall coating shall be RINOLGUARD applied in a minimum of two coats at a material consumption rate of 125 - 250 g/m² per coat.



No.1 in industrial flooring

RINOL Aktiengesellschaft
Benzstraße 2
D-71272 Renningen
Germany

Tel. + 49 / (0) 71 59 / 164-0
Fax + 49 / (0) 71 59 / 51 52
service@rinol.com

RINOL Asia Pacific (Holdings) Ltd.
Unit 1205, Bangna Tower A
Bangna - Trad Highway Km 6,5
Samutprakarn 10540
Thailand

Tel. + 662 7 51 96 04
Fax + 662 7 51 96 05
rinol.asia@rinol.com

www.rinol.com

IMPORTANT

Whilst all reasonable care is taken in compiling technical data on the company's products, all recommendations or suggestions regarding the use of such products are made without guarantee since the conditions of use are beyond the control of the company. It is the customer's responsibility to satisfy himself that each product is fit for the purpose for which he intends to use it and that the actual conditions of use are suitable.